

FORM FIT Side Window Visors
Installation Instructions

SD 22N17
Kia Niro (2017 - 2022)

Basic Required Hand Tools

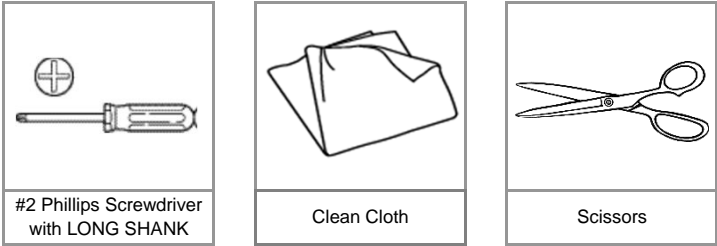

Notes to the Installer:

- Read the entire installation manual prior to beginning the installation of the accessory.
- Make sure the vehicle is clean and completely dry before installation.
- Make sure the vehicle is at room temperature or warmer: 15° to 43° C (60° to 110°F) before starting installation and that it remains at room temperature for 1 hour afterward to develop maximum adhesion of the 3M tape to the vehicle's surface.

1

2

3

4

X2

5

6

3M Primer 94 Instructions

- Squeeze tube in middle to break inner ampule.
- Apply to clean, dry surface.
- Allow at least 5 minutes to dry before taping.

#	Qty.	Description	#	Qty.	Description	#	Qty.	Description
1	1	Side window visors (set of 4)	7			13		
2	4	Adhesive pedestals	8			14		
3	2	Surface Cleaner	9			15		
4	4	Pins	10			16		
5	4	Screws	11					
6	2	Primer 94 Ampule	12					

Installation

- Make sure the vehicle is clean and completely dry before installation. Be aware any debris, oils, paint or surface treatment can effect the pedestal adhesiveness to the vehicle surface. Adhesive failure due to this is not covered under warranty.
- This product uses a 3M adhesive that requires installation and curing temperatures of 15° to 43°C (60° to 110°F) for 1 hr to develop maximum adhesion to the vehicle surface. Failure to install this product at the proper temperature or allow adequate curing time before use is not covered under warranty.
- Proper installation of the adhesive pedestal system requires the use of a #2 Phillips screwdriver. Use of the correct screw driver will facilitate a trouble free installation. Do not attempt to use #1 or smaller Phillips screwdriver or any type of electric screwdriver.

Care

Hand clean visors using a mild soap and water solution or plastic cleaner only.

Service

Periodically check to confirm the protector is securely attached to the vehicle.

Warning

Do not pull/push on the visor when opening/closing the door.

Note

The mirror has been eliminated from the drawings to facilitate a more clear view of the visor mounting location.

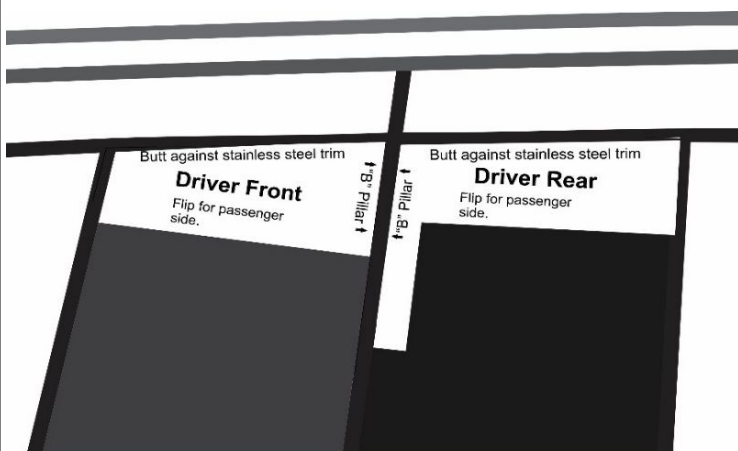
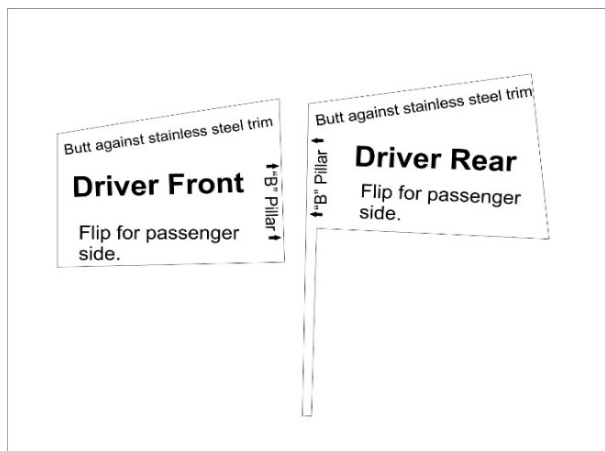

Cut out Templates

1

NOTE

Locate template sheet on the last page of the instruction sheet package. Cut out the templates

Position templates

2

NOTE

There are 2 templates. Each is labeled for its position. The templates will guide in the positioning of the mounting pedestals. As noted on the template, each is intended for a specific location. The templates do not need to be attached but it is vital they are correctly positioned to get the mounting pedestals in the correct position. Only position one pedestal at a time.

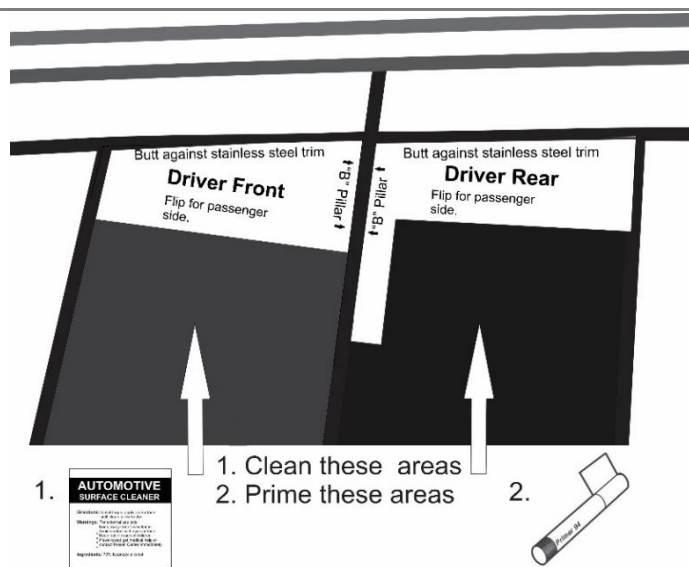
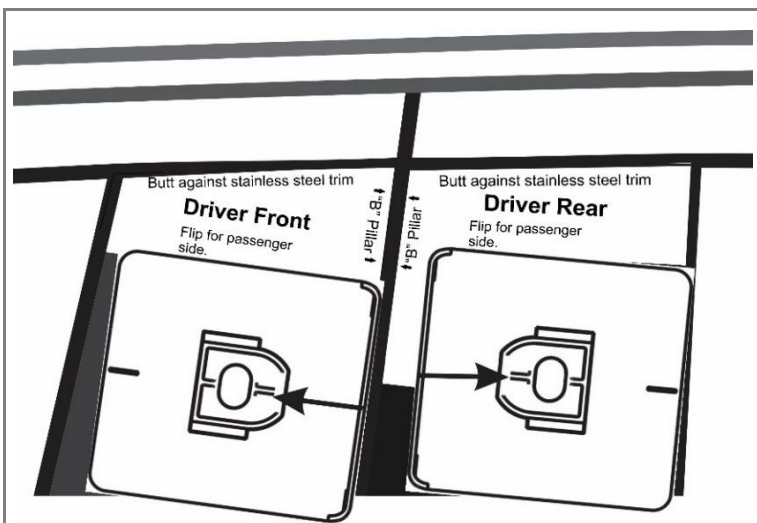

1.



1. Clean these areas
2. Prime these areas

2.



Mounting pedestal position

3

NOTE

Note the position of the mounting pedestals. The screw hole in the raised portion of the pedestal faces the door opening or "B" pillar. On the front door it faces rearward. On the rear door it faces forward.

DO NOT PEEL BACKING AND STICK PEDESTALS DOWN AT THIS POINT!!

Clean pedestal mounting areas

4

NOTE

Clean all the mounting areas aggressively with the automotive surface cleaner to remove any finger prints, oil or wax that may be on the surface. Wipe dry with a clean cloth or paper towel.



Using the 3M adhesive promoter, prime all the contact areas on the door frames where **the pedestals** mount. Allow to dry. Excess primer can be removed with alcohol.

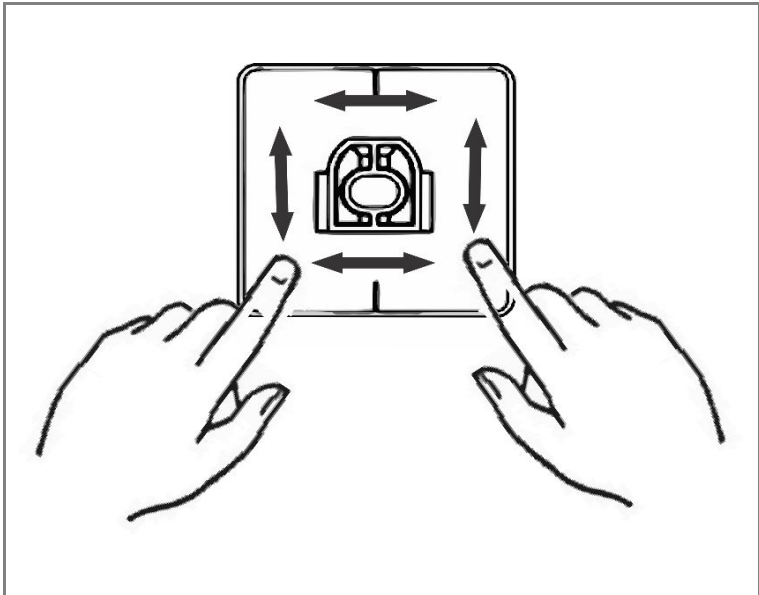

Place mounting pedestals

5

NOTE

One pedestal at a time, peel the protective backing and place each pedestal in its position. Take care when placing pedestals as the adhesive is very strong. Once stuck, it is very difficult to remove without destroying the pedestal. "Wet-out" the pedestals after sticking them down to ensure full contact with the adhesive surface.

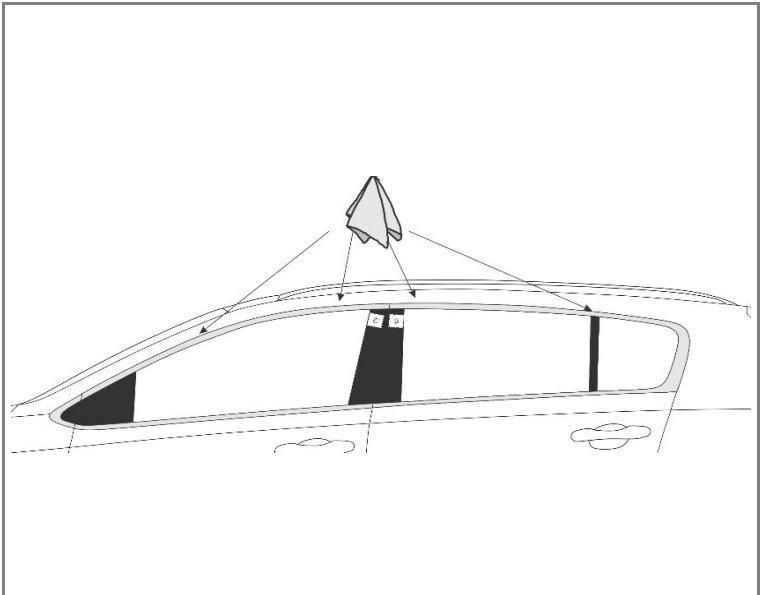

Clean mounting surface

6

NOTE

Ensure all mounting surfaces are clean and dry.

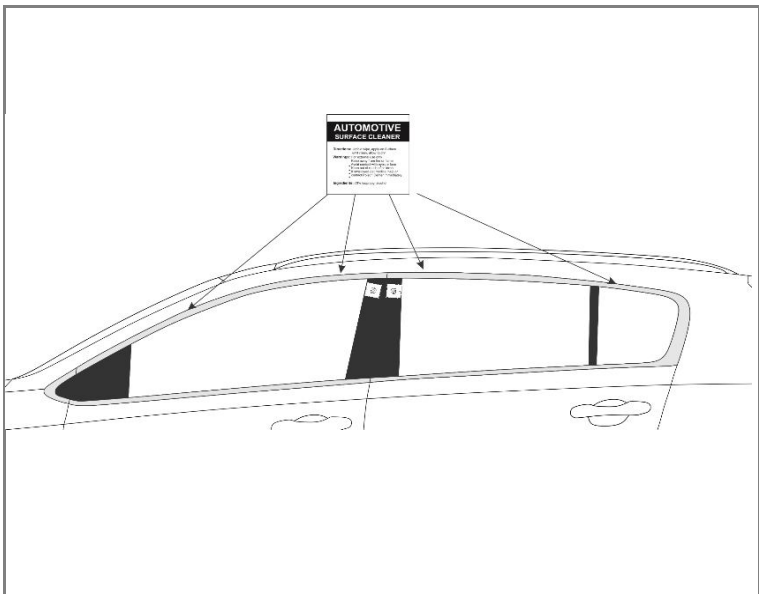

Clean with surface cleaner

7

NOTE

Clean all the mounting areas aggressively with the automotive surface cleaner to remove any finger prints, oil or wax that may be on the surface. Wipe dry with a clean cloth or paper towel.

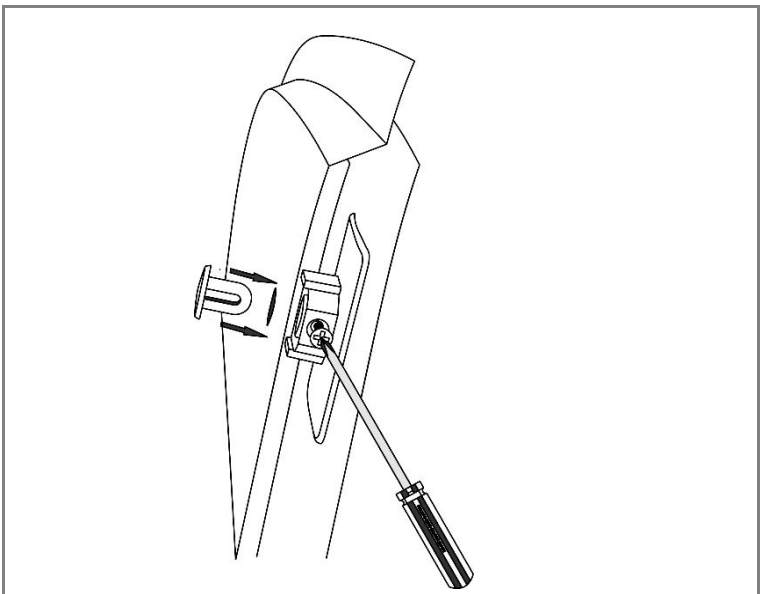

Mount visor on pedestal

8

NOTE

Mount visors one at a time, starting with the driver front. Place a screw in the screw hole in the mounting pedestal. Only turn it enough to keep it in place. Push a pin through the visor and into the mounting pedestal as shown. Turn the screw in a few turns but do not tighten in place. This will hold one end of the visor while you align the other.

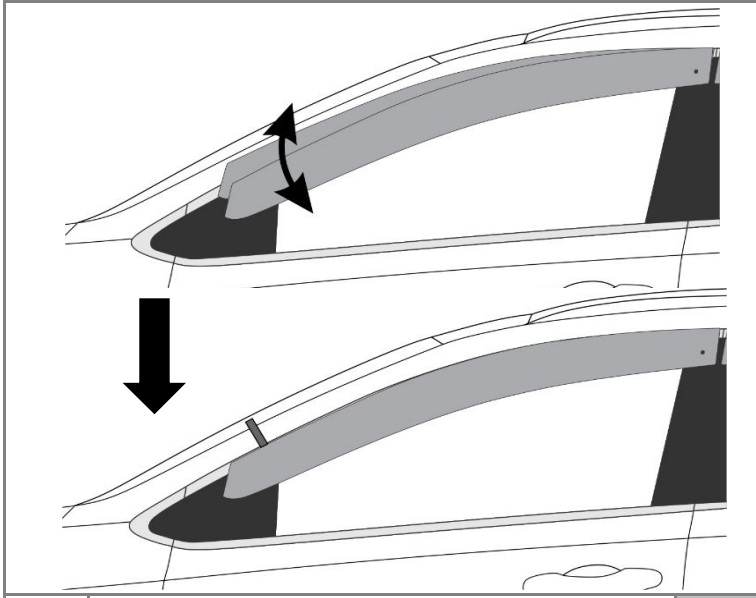

Position Visor

9

NOTE

Pivot the visor into position. The top edge of the visor should be flush with the top of the door frame. Peel a small quantity of the two-sided tape protective backing at the mirror base end so there is a small pull-tab. Do not press visor into place.

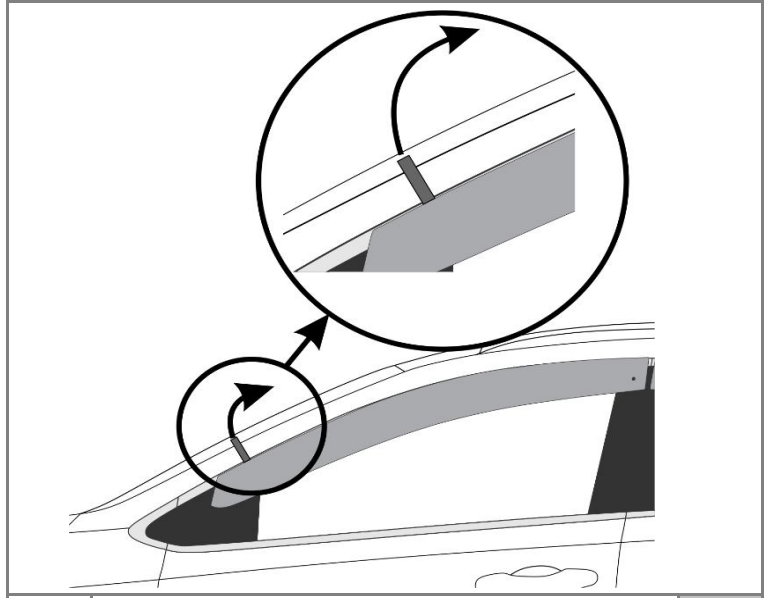

Stick visor in place

10

NOTE

Confirm visor placement. Press visor into place at the mirror base. Simultaneously peel backing and softly press into place while ensuring the placement remains correct. Once all the protective backing has been removed, press hard along the whole length to ensure the tape is properly adhered.

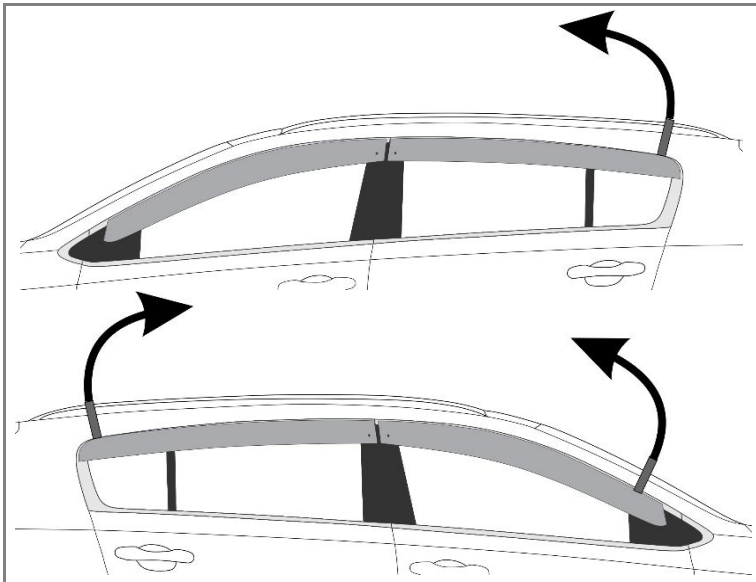

Attach remaining visors

11

NOTE

Repeat steps 8 through 10 for the remaining visors. Always start at the end opposite the "B" pillar when removing the protective backing.

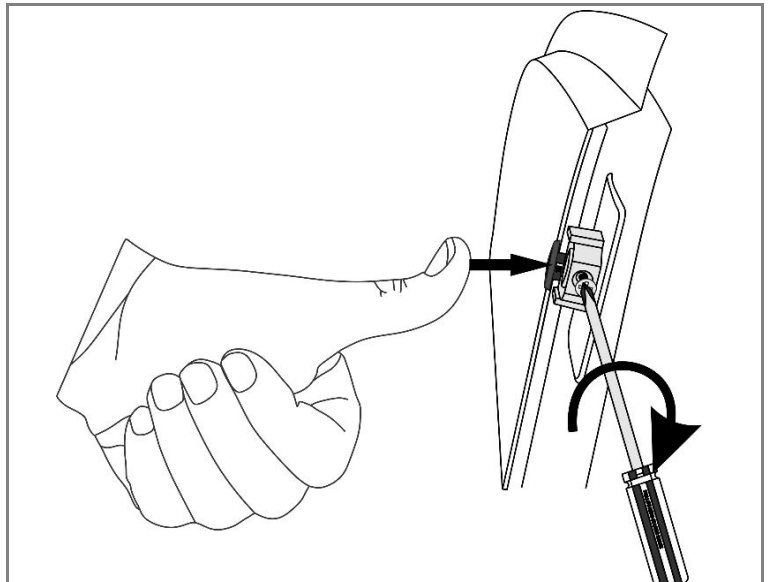

Tighten hardware

12

NOTE

Ensure the pin is properly seated and tighten the screw into the mounting pedestal on each visor. It will be necessary to open the front doors to do this. Take care to not overtighten the screw.

